

## ■ 共模濾波器

### COMMON-MODE CHOKE COILS

形狀和尺寸 (單位: mm) SHAPE AND DIMENSIONS (Unit: mm)

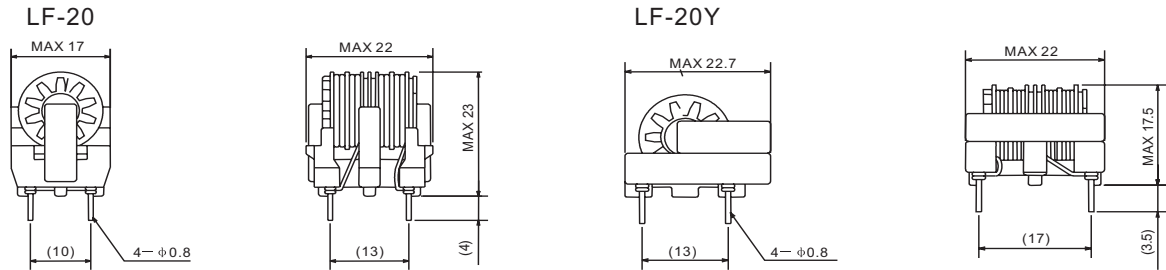

品名	電感值 [mH] MIN	電感偏差 [mH] MAX	直流電阻 [Ω] MAX	額定電流 [A]MAX
1R1A272F20(Y)	2.7	0.135	0.225	1.1
1R0A392F20(Y)	3.9	0.195	0.335	1.0
0R8A682F20(Y)	6.8	0.340	0.530	0.8
0R8A822F20(Y)	8.2	0.410	0.700	0.8
0R7A103F20(Y)	10.0	0.500	0.750	0.7
0R6A123F20(Y)	12.0	0.600	0.970	0.6
0R5A183F20(Y)	18.0	0.900	1.300	0.5
0R3A333F20(Y)	33.0	1.650	2.500	0.3
0R2A563F20(Y)	56.0	2.800	4.600	0.2
0R2A683F20(Y)	68.0	3.400	6.170	0.2

形狀和尺寸 (單位: mm) SHAPE AND DIMENSIONS (Unit:mm)

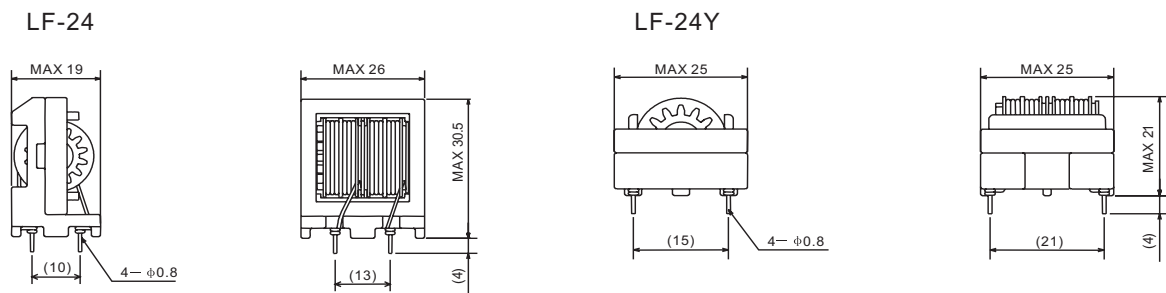

品名	電感值 [mH] MIN	電感偏差 [mH] MAX	直流電阻 [Ω] MAX	額定電流 [A]MAX
2R7A152F24(Y)	1.5	0.075	0.055	2.7
2R0A272F24(Y)	2.7	0.135	0.090	2.0
1R6A392F24(Y)	3.9	0.195	0.130	1.6
1R5A472F24(Y)	4.7	0.235	0.160	1.5
1R2A682F24(Y)	6.8	0.340	0.255	1.2
1R1A822F24(Y)	8.2	0.410	0.275	1.1
0R9A123F24(Y)	12.0	0.600	0.350	0.9
0R8A183F24(Y)	18.0	0.900	0.550	0.8
0R7A223F24(Y)	22.0	1.10	0.680	0.7
0R5A333F24(Y)	33.0	1.65	1.150	0.5

- Rated voltage: AC250V
- Test voltage: 2000VAC, one minute between lines
- Insulation resistance: at 500VDC, more than 100MΩ (between lines)
- Temperature range: -25℃ ~ T℃ (T=105-temp, rise)
- Thermal class: E (120℃)

※ 可以按照客戶要求的電感值和額定電流定制產品  
Custom-mode coils with different inductance and rated current available on request.

■ 共模濾波器  
COMMON-MODE CHOKE COILS

形狀和尺寸 (單位: mm) SHAPE AND DIMENSIONS (Unit:mm)

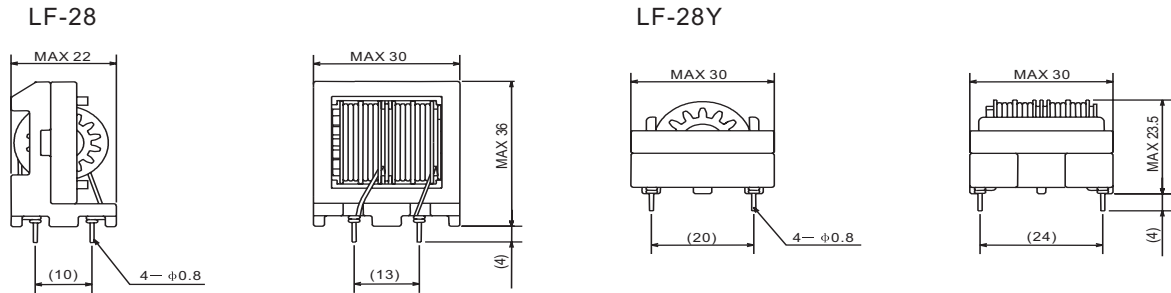

品名	電感值 [mH] MIN	電感偏差 [mH] MAX	直流電阻 [Ω] MAX	額定電流 [A]MAX
3R5A152F28(Y)	1.5	0.075	0.045	3.5
2R7A272F28(Y)	2.7	0.135	0.080	2.7
2R2A472F28(Y)	4.7	0.235	0.110	2.2
2R0A562F28(Y)	5.6	0.280	0.140	2.0
1R7A822F28(Y)	8.2	0.410	0.230	1.7
1R6A103F28(Y)	10.0	0.500	0.250	1.6
1R3A153F28(Y)	15.0	0.750	0.350	1.3
1R2A183F28(Y)	18.0	0.900	0.410	1.2
0R9A273F28(Y)	27.0	1.350	0.650	0.9
0R8A393F28(Y)	39.0	1.950	0.865	0.8

形狀和尺寸 (單位: mm) SHAPE AND DIMENSIONS (Unit:mm)

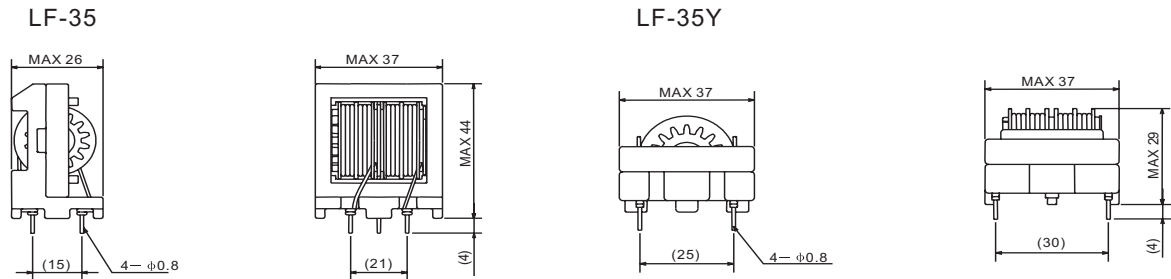

品名	電感值 [mH] MIN	電感偏差 [mH] MAX	直流電阻 [Ω] MAX	額定電流 [A]MAX
4R0A332F35(Y)	3.3	0.165	0.052	4.0
3R5A472F35(Y)	4.7	0.235	0.075	3.5
3R2A682F35(Y)	6.8	0.340	0.093	3.2
3R0A822F35(Y)	8.2	0.410	0.100	3.0
2R5A103F35(Y)	10.0	0.500	0.127	2.5
2R1A153F35(Y)	15.0	0.750	0.180	2.1
1R9A183F35(Y)	18.0	0.900	0.226	1.9
1R8A223F35(Y)	22.0	1.100	0.286	1.8
1R4A333F35(Y)	33.0	1.650	0.418	1.4
1R2A393F35(Y)	39.0	1.950	0.468	1.2

- Rated voltage: AC250V
- Test voltage: 2000VAC, one minute between lines
- Insulation resistance: at 500VDC, more than 100MΩ (between lines)
- Temperature range: -25℃ ~ T℃ (T=105-temp, rise)
- Thermal class: E (120℃)

※ 可以按照客戶要求的電感值和額定電流定制產品  
Custom-mode coils with different inductance and rated current available on request.

## ■ 共模濾波器

### COMMON-MODE CHOKE COILS

形狀和尺寸 (單位: mm) SHAPE AND DIMENSIONS (Unit:mm)

UU-9

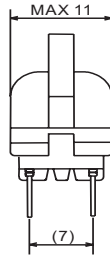
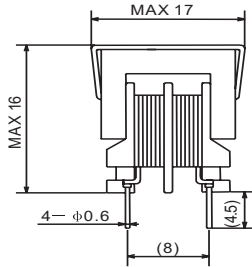

UU-9Y

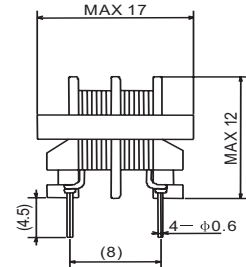
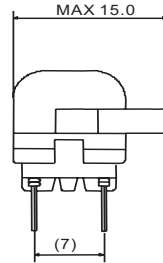

品名	電感值 [mH] MIN	電感偏差 [mH] MAX	直流電阻 [Ω] MAX	額定電流 [A]MAX
0R8A801U9(Y)	0.8	0.040	0.34	0.80
0R8A102U9(Y)	1.0	0.050	0.50	0.80
0R6A152U9(Y)	1.5	0.075	0.52	0.60
0R54A202U9(Y)	2.0	0.100	1.00	0.54
0R42A302U9(Y)	3.0	0.150	1.50	0.42
0R32A502U9(Y)	5.0	0.250	2.50	0.32
0R25A802U9(Y)	8.0	0.400	4.00	0.25
0R23A103U9(Y)	10.0	0.500	4.50	0.23
0R2A153U9(Y)	15.0	0.750	5.50	0.20
0R2A203U9(Y)	20.0	1.000	7.50	0.20

形狀和尺寸 (單位: mm) SHAPE AND DIMENSIONS (Unit:mm)

UU-10.5

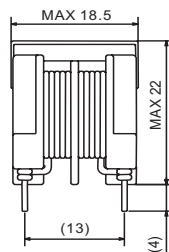
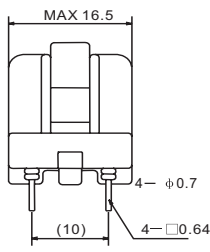

UU-10.5Y

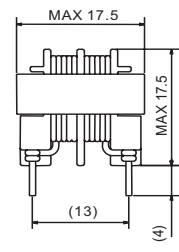
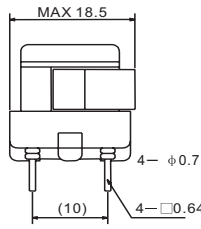

品名	電感值 [mH] MIN	電感偏差 [mH] MAX	直流電阻 [Ω] MAX	額定電流 [A]MAX
2R0A601U10(Y)	0.6	0.030	0.069	2.0
1R5A102U10(Y)	1.0	0.050	0.120	1.5
1R2A202U10(Y)	2.0	0.100	0.225	1.2
1R0A302U10(Y)	3.0	0.150	0.370	1.0
0R9A502U10(Y)	5.0	0.250	0.480	0.9
0R7A802U10(Y)	8.0	0.400	0.760	0.7
0R4A123U10(Y)	12.0	0.600	1.300	0.4

- Rated voltage: AC250V
- Test voltage: 2000VAC, one minute between lines
- Insulation resistance: at 500VDC, more than 100MΩ (between lines)
- Temperature range: -25°C ~ T°C (T=105-temp, rise)
- Thermal class: E (120°C)

※ 可以按照客戶要求的電感值和額定電流定制產品  
Custom-mode coils with different inductance and rated current available on request.

# 共模濾波器 COMMON-MODE CHOKE COILS

## ■ 共模濾波器 COMMON-MODE CHOKE COILS

形狀和尺寸(單位: mm) SHAPE AND DIMENSIONS (Unit:mm)

UU-16

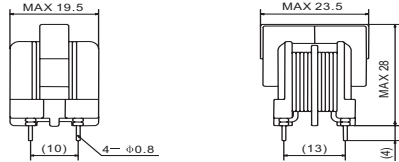

品名	電感值 [mH] MIN	電感偏差 [mH] MAX	直流電阻 [Ω] MAX	額定電流 [A]MAX
2R0A102U16	1.0	0.050	0.078	2.0
2R0A202U16	2.0	0.100	0.100	2.0
1R5A302U16	3.0	0.150	0.170	1.5
1R5A352U16	3.5	0.175	0.183	1.5
1R4A502U16	5.0	0.250	0.200	1.4
1R1A802U16	8.0	0.400	0.372	1.1
1R0A103U16	10.0	0.500	0.480	1.0
0R9A123U16	12.0	0.600	0.550	0.9
0R8A183U16	18.0	0.900	0.832	0.8

形狀和尺寸(單位: mm) SHAPE AND DIMENSIONS (Unit:mm)

DRB-18

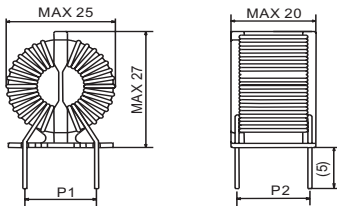

品名	P1	P2
DRB18-02A102	14	15
DRB18-02A202	14	15
DRB18-02A302	14	15
DRB18-02A502	14	15
DRB18-03A102	10	16
DRB18-03A202	10	16
DRB18-03A302	10	16
DRB18-05A102	10	16

DRC-18

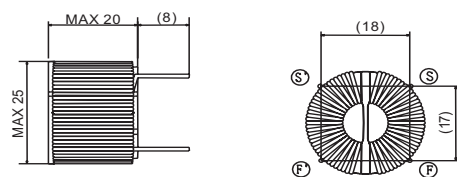

品名	電感值 [mH] ±30%以內	電感偏差 [mH] MAX	直流電阻 Ω ±20%以內	額定電流 [A]MAX
DRB18-02A102	1.0	0.050	0.024	2.0
DRB18-02A202	2.0	0.100	0.031	2.0
DRB18-02A302	3.0	0.150	0.041	2.0
DRB18-02A502	5.0	0.250	0.049	2.0
DRB18-03A102	1.0	0.050	0.014	3.0
DRB18-03A202	2.0	0.100	0.020	3.0
DRB18-03A302	3.0	0.150	0.024	3.0
DRB18-05A102	1.0	0.050	0.010	5.0
DRC18-02A102	1.0	0.050	0.024	2.0
DRC18-02A202	2.0	0.100	0.031	2.0
DRC18-02A302	3.0	0.150	0.041	2.0
DRC18-02A502	5.0	0.250	0.049	2.0
DRC18-03A102	1.0	0.050	0.014	3.0
DRC18-03A202	2.0	0.100	0.020	3.0
DRC18-03A302	3.0	0.150	0.024	3.0
DRC18-05A102	1.0	0.050	0.010	5.0

- Rated voltage: AC250V
- Test voltage: 2000VAC, one minute between lines
- Insulation resistance: at 500VDC, more than 100MΩ (between lines)
- Temperature range: -25°C ~ T°C (T=105-temp, rise)
- Thermal class: E (120°C)

※ 可以按照客戶要求的電感值和額定電流定制產品  
Custom-mode coils with different inductance and rated current available on request.

**共模濾波器**
**COMMON—MODE CHOKE COILS**

形状和尺寸 (单位: mm) SHAPE AND DIMENSIONS (Unit:mm)

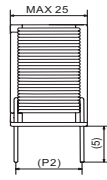
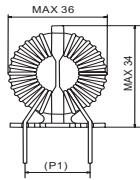
**DRB-25**

品名	P1	P2
DRB(C)25-05A202	12	17
DRB(C)25-10A102	18	16
DRB(C)25-15A601	18	16
DRB(C)25-3.5A802	12	17
DRB(C)25-05A502	12	17
DRB(C)25-08A352	18	16

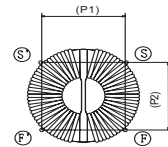
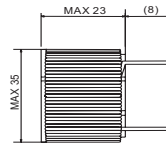
**DRC-25**

品名	电感值 [mH] MIN	电感偏差 [mH] MAX	直流电阻 Ω ± 20%以内	额定电流 [A]MAX
DRB25-05A202	2.0	0.100	0.0190	5.0
DRB25-10A102	1.0	0.050	0.0082	10.0
DRB25-15A601	0.6	0.030	0.0043	15.0
DRB25-3.5A802	8.0	0.400	0.0510	3.5
DRB25-05A502	5.0	0.250	0.0280	5.0
DRB25-08A352	3.5	0.175	0.0170	8.0
DRC25-05A202	2.0	0.100	0.0190	5.0
DRC25-10A102	1.0	0.050	0.0082	10.0
DRC25-15A601	0.6	0.030	0.0043	15.0
DRC25-3.5A802	8.0	0.400	0.0510	3.5
DRC25-05A502	5.0	0.250	0.0280	5.0
DRC25-08A352	3.5	0.175	0.0170	8.0

形状和尺寸 (单位: mm) SHAPE AND DIMENSIONS (Unit:mm)

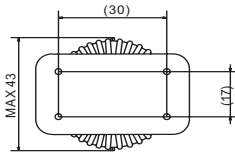
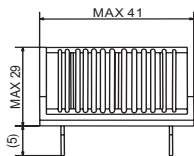
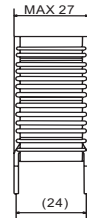
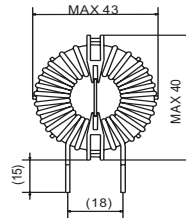
**DRB-31**

**DRC-31**

品名	电感值 [mH] MIN	电感偏差 [mH] MAX	直流电阻 [Ω] MAX	额定电流 [A]MAX
DRB31-20A701	0.7	0.035	0.005	20
DRB31-15A701	0.7	0.035	0.008	15
DRB31-15A142	1.4	0.070	0.010	15
DRB31-15A172	1.7	0.085	0.012	15
DRB31-15A202	2.0	0.100	0.014	15
DRB31-10A252	2.5	0.125	0.016	10
DRC31-20A701	0.7	0.035	0.005	20
DRC31-15A701	0.7	0.035	0.008	15
DRC31-15A142	1.4	0.070	0.010	15
DRC31-15A172	1.7	0.085	0.012	15
DRC31-15A202	2.0	0.100	0.014	15
DRC31-10A252	2.5	0.125	0.016	10

- Rated voltage: AC250V
- Test voltage: 2000VAC, one minute between lines
- Insulation resistance: at 500VDC, more than 100MΩ (between lines)
- Temperature range: -25℃ ~ T℃ (T=105-temp, rise)
- Thermal class: E (120℃)

※ 可以按照客户要求的电感值和额定电流定制产品

Custom-mode coils with different inductance and rated current available on request.