

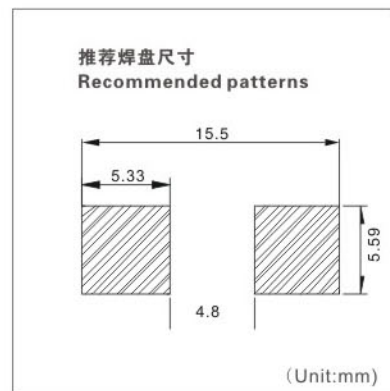

B RCSCF Series 系列 贴片组立式大电流电感 RCSCF 系列

RCSCF 29 Series 系列

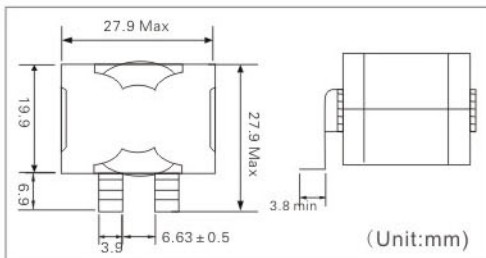
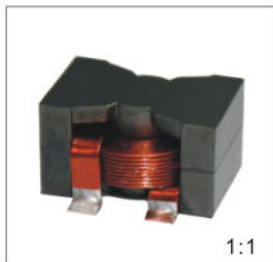

电气性能 Electrical characteristics

RCSCF 2915 系列

产品编号 Part No.	电感值 Inductance L(uH) ± 20%	直流电阻(mΩ)DCResistance		温升电流 Heat Rated Current (A)Max	饱和电流 Saturation Current (A)Max	厚度 Thickness (mm)Max
		Typical	Max			
RCSCF2915-1R5M	1.5	1.5	1.65	30.0	100.0	15.0
RCSCF2915-2R2M	2.2	1.7	1.8	29.0	84.0	15.0
RCSCF2915-3R3M	3.3	1.8	1.9	27.0	54.0	15.0
RCSCF2915-4R7M	4.7	1.9	2.0	25.0	37.0	15.0
RCSCF2915-6R8M	6.8	2.1	2.2	22.0	26.0	15.0
RCSCF2915-100M	10.0	2.3	2.5	18.0	16.0	15.0
RCSCF2915-150M	15.0	2.7	2.9	16.0	9.8	15.0
RCSCF2915-220M	22.0	3.0	3.3	13.0	6.0	15.0
RCSCF2915-330M	33.0	3.7	4.0	9.0	2.6	15.0

直流重叠、温升特性曲线图 DC Bias & Temperature Characteristics

RCSCF 2915 系列

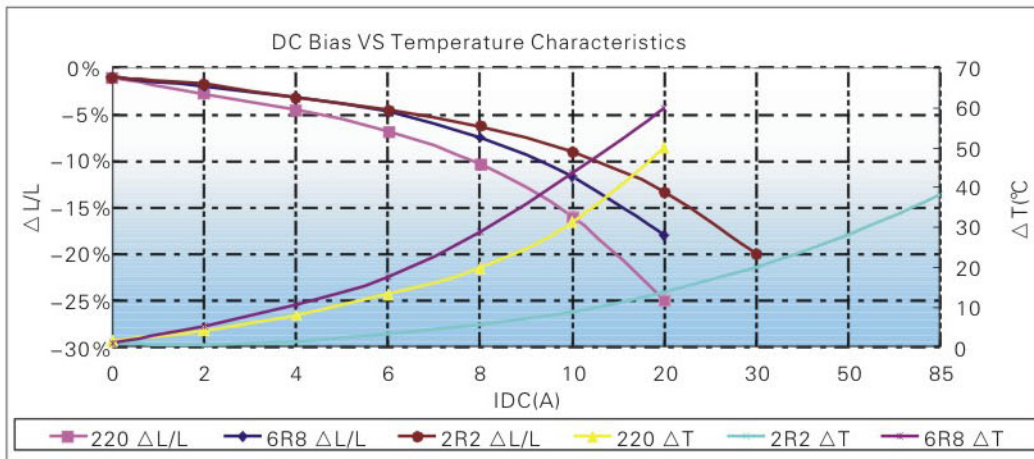

* 规格和参数仅供参考，更多的型号与规格，请关注我司网站或来电咨询。

The specifications and parameters are for reference only. More model and specification, Pay attention to our website or to inquire.